

Baldus Scavenger System

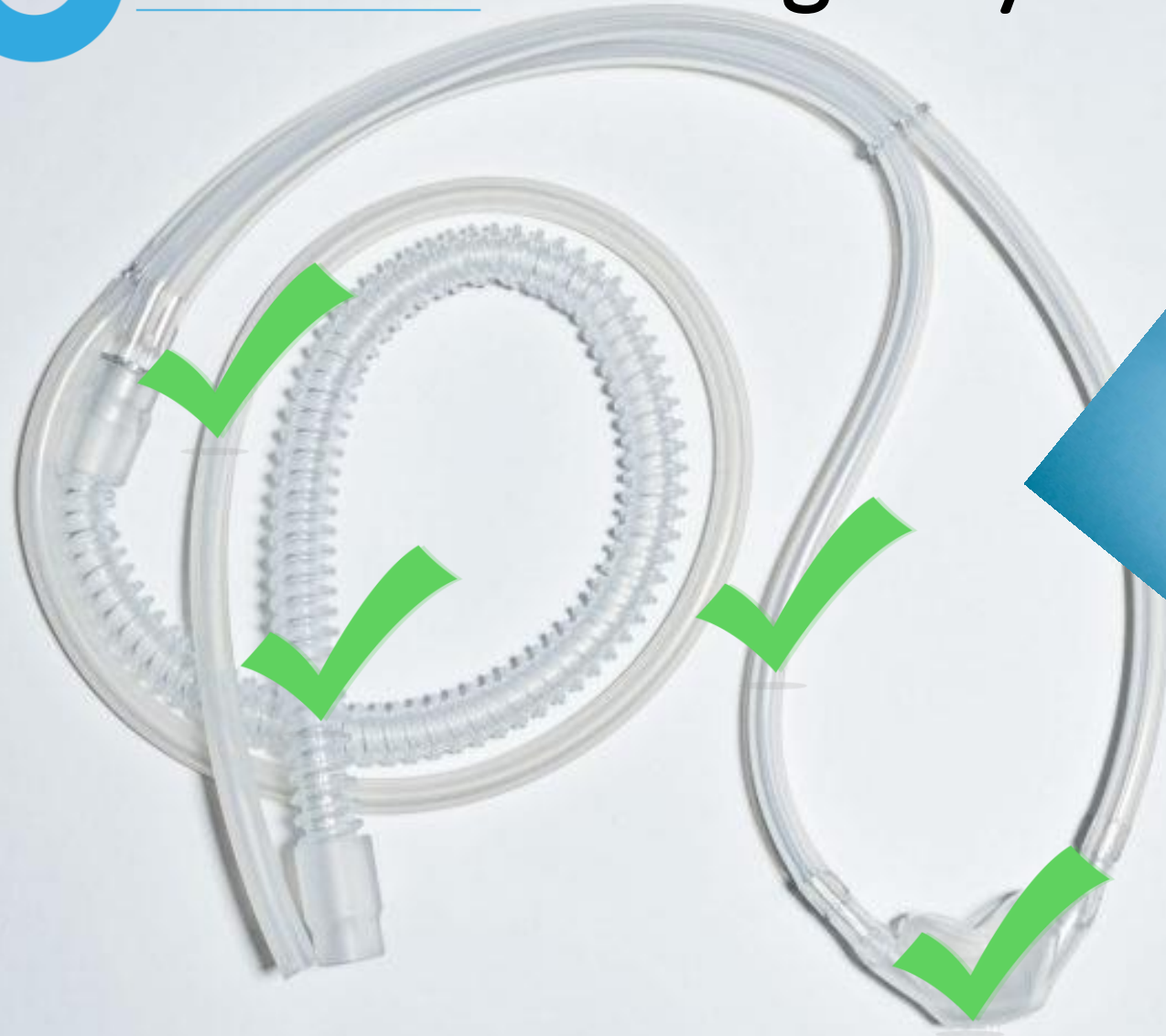

Baldus Scavenger System

- **Allowed Component Sterilization – Steam Autoclave - 134°C (ISO 11607)**
 - Outer Mask
 - Inner Mask
 - Double Hose
 - Vacuum Hose
 - Corrugated Gas Supply Hose
 - Connectors, Sliders, Y-Connectors, and Hangers
 - Breathing Bag
- **Not Allowed Component Sterilization**
 - Vacuum Control Block

Accutron Scavenger System

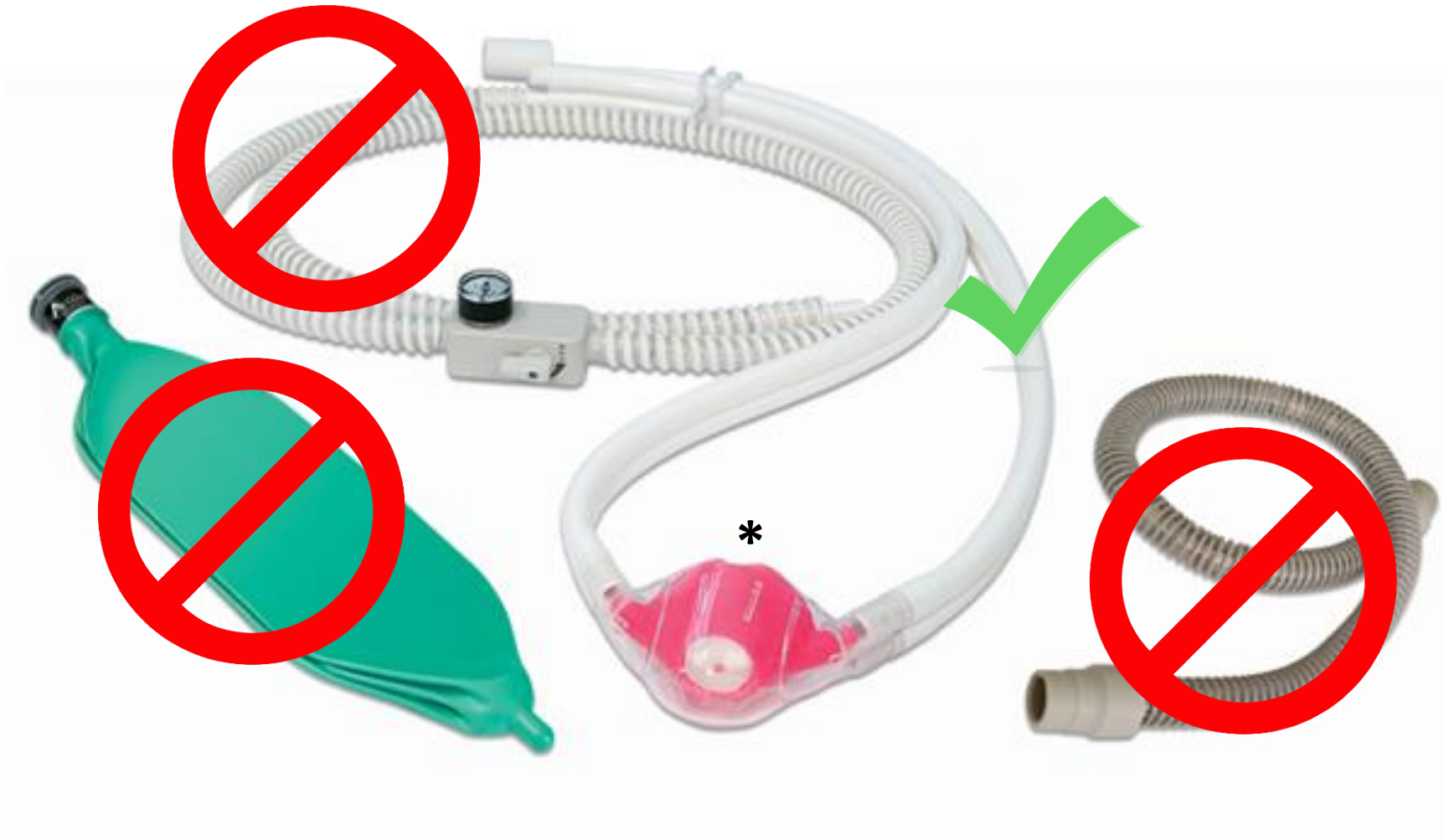

Accutron Scavenger System

- **Allowed Component Sterilization – Steam Autoclave - 134°C**
 - White Tubing
 - White Fittings

- **Not Allowed Component Sterilization**
 - Corrugated Mixing Gas Tubing
 - Corrugated Vacuum Tubing
 - Mixing Bag
 - In-Line Vacuum Controller
 - * Single Use Nasal Mask

Porter Scavenger System

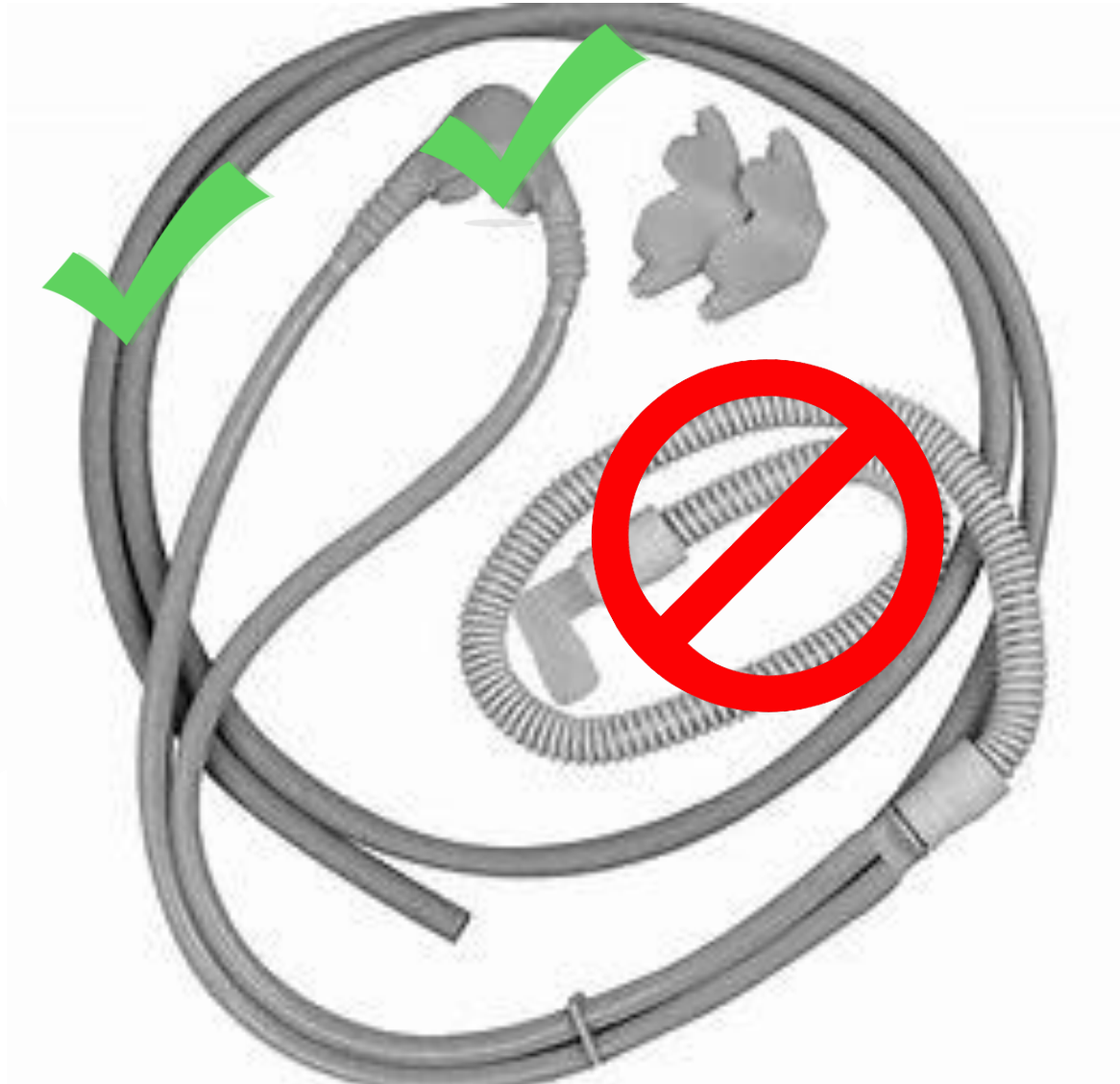

Porter Scavenger System

- **Allowed Component Sterilization – Steam Autoclave - 134°C**
 - Nasal Hood
 - Nasal Liners
 - Coaxial Tubing Assembly
- **Not Allowed Component Sterilization**
 - Fresh Gas Corrugated Tubing
 - Corrugated Vacuum Tubing
 - Latex Mixing Bag (Contain Natural Rubber Latex)
 - Vacuum Control Valve



Baldus



Accutron



Porter

	Baldus	Accutron	Porter
• Autoclavable Double Mask System	✓	✗	✓
• Autoclavable Outer Mask	✓	✗	✓
• Autoclavable Inner Mask	✓	✗	✓
• Autoclavable Double Tubing	✓	✓	✓
• Autoclavable Vacuum Tubing	✓	✗	✗
• Autoclavable Corrugated Gas Supply Tubing	✓	✗	✗
• Autoclavable Breathing Bag	✓	✗	✗



Is the ONLY Completely Autoclavable System
For More Complete Hygiene and Safety